

PLEASE KEEP THESE INSTRUCTIONS ON HAND FOR FUTURE TESTING

Flowflex™

**SARS-CoV-2 Antigen Rapid Test
(Self-Testing)
Package Insert**

| | | | |
|----------------|----------------|----------------|---------|
| REF L031-118M5 | REF L031-118N5 | REF L031-118W5 | English |
| REF L031-118P5 | REF L031-118Z5 | REF L031-118R5 | |

A rapid test for the detection of SARS-CoV-2 nucleocapsid antigens in anterior nasal swab specimens.

For in vitro diagnostic use only. For self-testing.

Carefully read the instructions before performing the test.

PREPARATION

1.

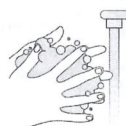

Wash or sanitize your hands. Make sure they are dry before starting the test.

2.

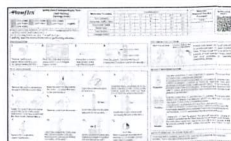

Read the instructions before using SARS-CoV-2 Antigen Rapid Test kit.

3.



Check the expiration date printed on the cassette foil pouch.

4.

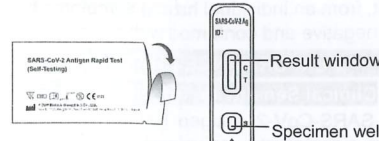

Open the pouch. Check for the Result window and Specimen well on the cassette.

SPECIMEN COLLECTION

SELF COLLECTION



COLLECTION BY AN ADULT CAREGIVER



A nasal swab sample can be self-collected by an individual aged 18+ years. Children under 18 years of age should be performed by a parent or legal guardian. Please follow your local guidelines for specimen collection by children.

INSTRUCTION VIDEO:



TEST PROCEDURE

1.



Remove the aluminum foil from the top of extraction buffer tube.

2.

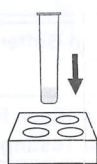

Insert the tube into the hole on the kit box. (Or place the tube in the tube holder.)

3.



Open the swab packaging at stick end. **Caution:** Do not touch the absorbent tip of the swab with your hands.

4.



Insert the entire absorbent tip of the swab into one nostril. Using gentle rotation, push the swab less than 2.5 cm from the edge of the nostril.

5.



Rotate the swab 5 times brushing against the inside of the nostril. Remove the swab and insert it into the other nostril. Repeat step 4.

6.

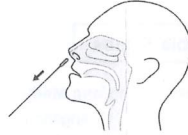

Remove swab from the nostril.

7.

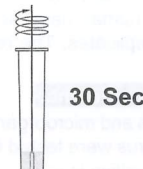

Insert the swab into the tube and swirl for 30 seconds.

8.

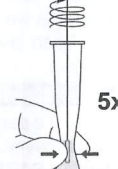

Rotate the swab 5 times while squeezing the side of the tube.

9.



Remove the swab while squeezing the tube.

10.



Attach the dropper tip firmly onto the extraction buffer tube. Mix thoroughly by swirling or flicking the bottom of the tube.

11.



Gently squeeze the tube and dispense 4 drops of solution into the Specimen well.

12.



Read the result when the timer reaches 15-30 minutes. Do not read after 30 minutes.

RESULT INTERPRETATION



Negative

Only the control line (C) and no test line (T) appears. This means that no SARS-CoV-2 antigen was detected.

A negative test result indicates that you are unlikely to currently have COVID-19 disease. Continue to follow all applicable rules and protective measures when contacting with others. There may be an infection even if the test is negative. If it is suspected, repeat the test after 1 - 2 days, as the coronavirus cannot be precisely detected in all phases of an infection.

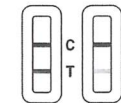

Positive

Both the control line (C) and test line (T) appears. This means that SARS-CoV-2 antigen was detected. **NOTE:** Any faint line in the test line region (T) should be considered positive.

A positive test result means it is very likely you currently have COVID-19 disease. Contact your doctor / general practitioner or the local health department immediately. Follow the local guidelines for self-isolation. A PCR confirmation test should be carried out.

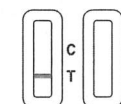

Invalid

Control line (C) fails to appear. Not enough specimen volume or incorrect operation are the likely reasons for an invalid result. Review the instructions again and repeat the test with a new cassette. If the test results remain invalid, contact your doctor or a COVID-19 test center.

SAFELY DISPOSE OF YOUR TEST KIT

Once your test is complete, put all of the used test kit contents in the waste bag provided. Put in your general household waste.